

COVER PLAN

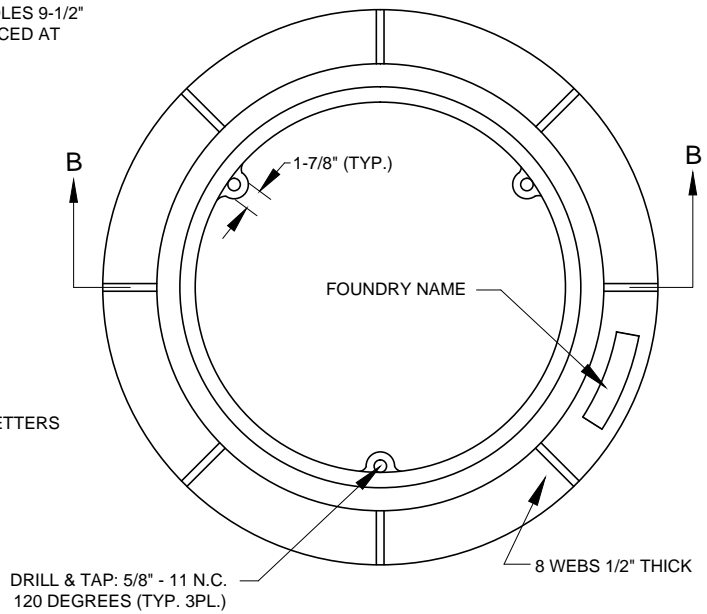

RING PLAN

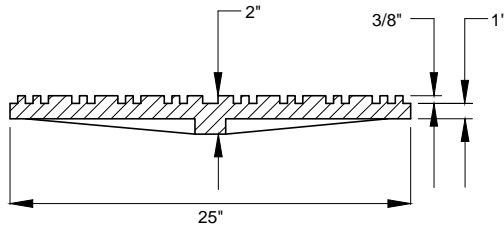

SECTION A-A

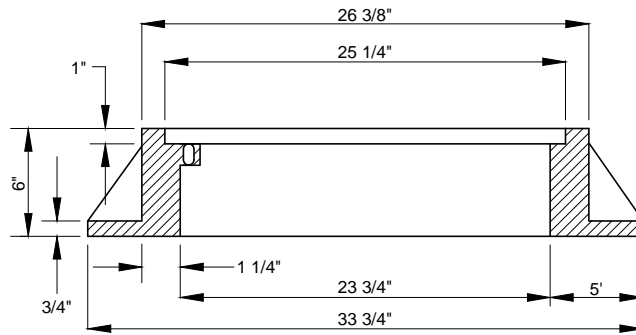

SECTION B-B

COVER NOTES:

1. USE WITH THREE LOCKING BOLTS 5/8"-11 NC STAINLESS TYPE 304 STEEL SOCKET HEAD (ALLEN HEAD) BOLTS, 2" LONG. DRILL HOLES SPACED 120°, TO MATCH HOLES IN RING.
2. COVER MATERIAL IS DUCTILE IRON ASTM A536 GRADE 80-55-06.
3. SHALL CONFORM TO SEC. 9-05.15 OF THE STANDARD SPECIFICATIONS, AS MODIFIED HEREIN.
4. APPROXIMATE WEIGHT OF COVER IS 150 LBS.
5. RATING - H20.

RING NOTES:

1. DRILL AND TAP THREE 5/8"-11 NC HOLES THROUGH RING AT 120°.
2. RING MATERIAL IS GREY IRON, ASTM A-48 CLASS 30.
3. SHALL CONFORM TO SEC. 9-05.15 OF THE STANDARD SPECIFICATIONS, AS MODIFIED HEREIN.
4. APPROXIMATE WEIGHT OF RING IS 215 LBS.
5. RATING - H20.

OLYMPIC FOUNDRY MH30AD/T , OR APPROVED EQUAL.

SPECIAL NOTE: THE USE OF A COMPOSITE FRAME AND COVER MADE OF FIBER REINFORCED POLYMERS MAY BE USED, BUT WILL HAVE TO MEET SAME SPECIFICATIONS AS DUCTILE IRON.

 <p>City of Bremerton</p> <p>PUBLIC WORKS</p> <p>DESIGN/CONSTRUCTION STANDARDS</p>	<p>MANHOLE RING AND COVER</p> <p>Alteration of this drawing is prohibited. Any approval of an altered drawing is unauthorized and void.</p>	<p>6005</p>
		<p>Revision Date 9/18/14</p>